

**2014
Sequoia
Quick Reference Guide**

2014 Sequoia

This *Quick Reference Guide* is a summary of basic vehicle operations. It contains brief descriptions of fundamental operations so you can locate and use the vehicle's main equipment quickly and easily.

The *Quick Reference Guide* is not intended as a substitute for the *Owner's Manual* located in your vehicle's glove box. We strongly encourage you to review the *Owner's Manual* and supplementary manuals so you will have a better understanding of your vehicle's capabilities and limitations.

Your dealership and the entire staff of Toyota Motor Sales, U.S.A., Inc. wish you many years of satisfied driving in your new Sequoia.

A word about safe vehicle operations

This *Quick Reference Guide* is not a full description of Sequoia operations. Every Sequoia owner should review the *Owner's Manual* that accompanies this vehicle.

Pay special attention to the boxed information highlighted in color throughout the *Owner's Manual*. Each box contains safe operating instructions to help you avoid injury or equipment malfunction.

All information in this *Quick Reference Guide* is current at the time of printing. Toyota reserves the right to make changes at any time without notice.

INDEX

OVERVIEW

| | |
|----------------------------------|----------|
| Engine maintenance | 10 |
| Fuel tank door release and cap | 9 |
| Hood release | 10 |
| Indicator symbols | 6-7 |
| Instrument cluster | 5 |
| Instrument panel | 2-4 |
| Keyless entry¹ | 8 |
| Light control-Instrument panel | 9 |

FEATURES/OPERATIONS

| | |
|--|-----------|
| Accessory meter | 20 |
| Air Conditioning/Heating | 22-23 |
| Audio | 24-25 |
| Auto lock/unlock¹ | 11 |
| Automatic Transmission | 11 |
| BSM (Blind Spot Monitor) | 13 |
| Cruise control | 28 |
| Cup holders | 33 |
| Door locks | 30 |
| Door-Power back | 19 |
| Dynamic Laser Cruise Control | 29 |
| Entune™ Audio Plus | 26 |
| Four-wheel drive | 12 |
| Garage door opener (HomeLink®) ³ | 28 |
| Lights¹ & turn signals | 17 |
| Moonroof | 20 |
| Multi-Information Display² | 30 |
| Parking brake | 12 |
| Power outlets-12V DC | 32 |
| Power outlets-120V AC | 32 |
| Rear seat entertainment system | 33 |
| Seat adjustments-Front | 15 |
| Seat adjustments-Rear | 14 |
| Seat ventilators/heaters | 23 |
| Seats-Folding second row seats | 15 |
| Seats-Folding third row seats | 16 |
| Seats-Head restraints | 13 |
| Telephone controls (Bluetooth®) | 31 |
| Tilt and telescopic steering wheel | 21 |
| Traffic | 27 |
| TOW/HAUL switch | 11 |
| VSC OFF switch | 21 |
| Weather | 27 |
| Window-Back | 19 |
| Windows | 18 |
| Windshield wipers & washers | 18 |

SAFETY AND

EMERGENCY FEATURES

| | |
|---|-------|
| Doors-Child safety locks | 35 |
| Floor mat installation | 37 |
| Seat belts | 34 |
| Seat belts-Shoulder belt anchor | 35 |
| Spare tire & tools | 33 |
| Star Safety System™ | 36-37 |
| Tire Pressure Monitoring (warning) System | 35 |

¹ Visit your Toyota dealer for information on customizing this feature.

² Programmable by customer. Refer to the *Owner's Manual* for instructions and more information.

³ HomeLink® is a registered trademark of Johnson Controls, Inc.

OVERVIEW

Instrument panel

Steering wheel controls (if equipped)

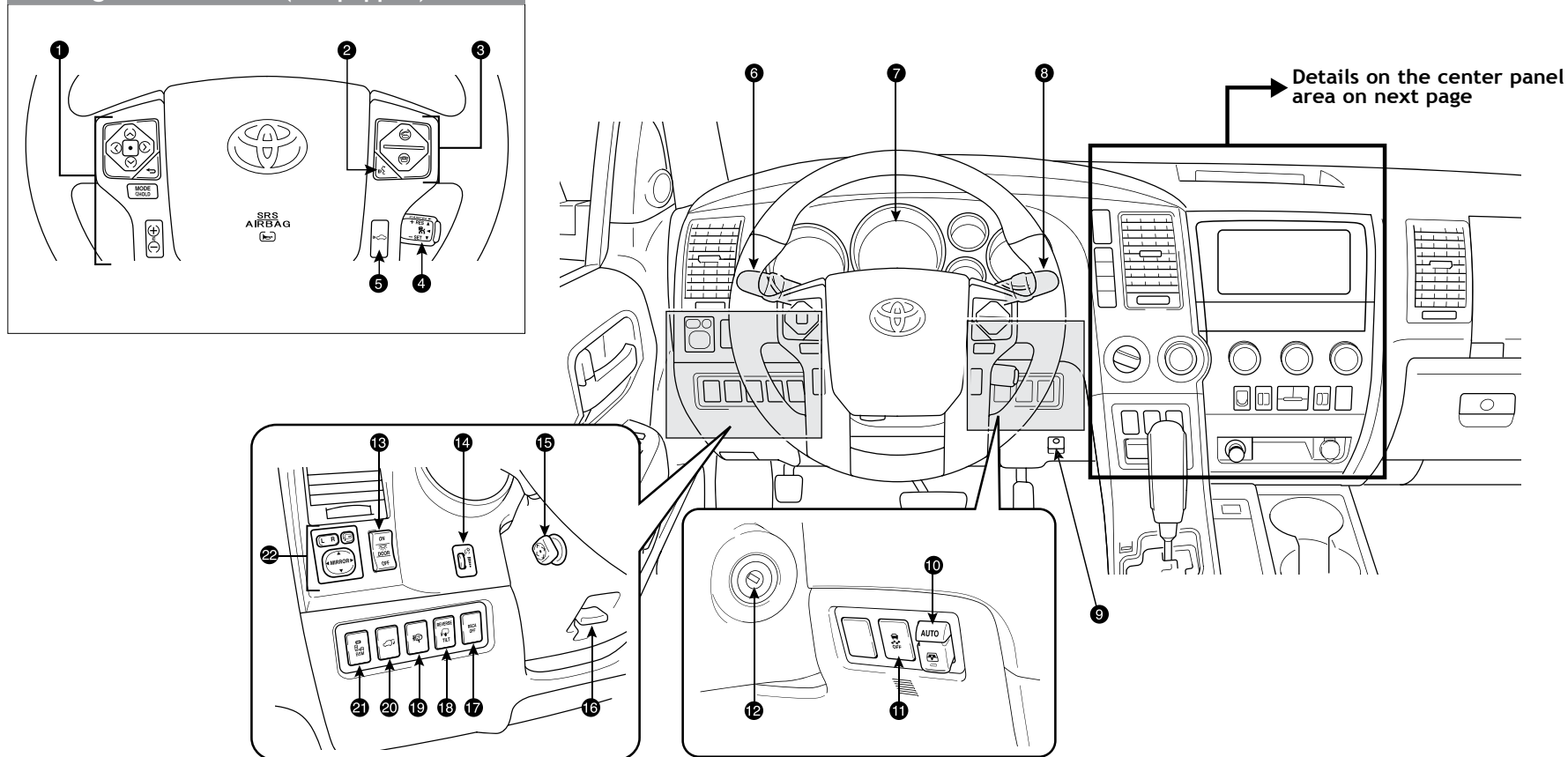

- ① Steering wheel audio controls^{1,2}
- ② Voice command button^{1,2}
- ③ Telephone controls^{1,2}
- ④ Cruise control
- ⑤ Dynamic Laser Cruise Control distance switch¹
- ⑥ Headlight, turn signal and front fog light¹ controls
- ⑦ Gauges and meters
- ⑧ Wiper and washer controls
- ⑨ Tire Pressure Monitoring (warning) System reset
- ⑩ Power back window switch
- ⑪ VSC OFF switch
- ⑫ Ignition switch
- ⑬ Personal/Interior light main switch
- ⑭ Instrument panel light control
- ⑮ Tilt and telescopic steering control switch¹

- ⑯ Tilt and telescopic steering lock release lever¹
- ⑰ Roll Sensing of Curtain shield Airbag OFF switch¹
- ⑱ REVERSE TILT (side mirrors) switch¹
- ⑲ Headlight cleaner¹
- ⑳ Power back door button¹
- ㉑ BSM (Blind Spot Monitor) main switch¹
- ㉒ Power rearview mirror controls

¹ If equipped

² For details, refer to the “Navigation System Owner’s Manual.”

Center panel area

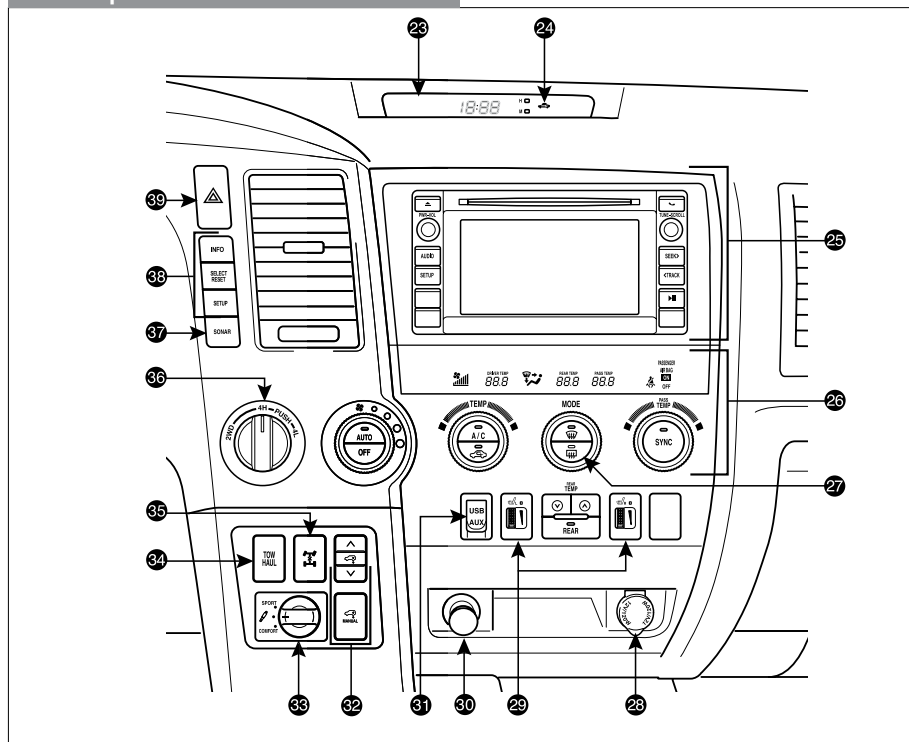

- 23 Accessory meter
- 24 Theft deterrent/Engine immobilizer system indicator
- 25 Multimedia system¹
- 26 Air Conditioning controls
- 27 Outside rearview mirror defogger²/Back window defogger/Windshield wiper de-icer button²
- 28 12V DC power outlet
- 29 Seat heater² and ventilator² controls
- 30 Cigarette lighter
- 31 AUX audio jack/USB port
- 32 Height control switch²
- 33 AVS switch²
- 34 TOW/HAUL button²
- 35 Center differential lock/unlock switch²
- 36 Front-wheel drive control switch²
- 37 Intuitive parking assist button²
- 38 Multi-Information Display control buttons² and/or accessory meter control buttons²
- 39 Emergency flasher button

¹ Vehicles with navigation system: for details, refer to the “*Navigation System Owner’s Manual*.”

² If equipped

Instrument cluster

With Multi-Information Display

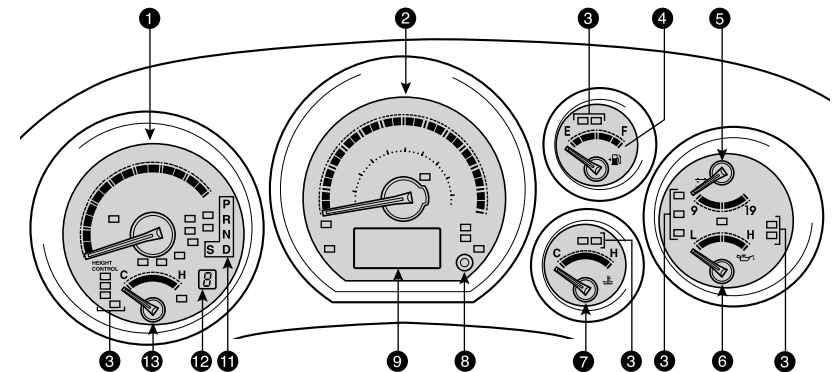

Without Multi-Information Display

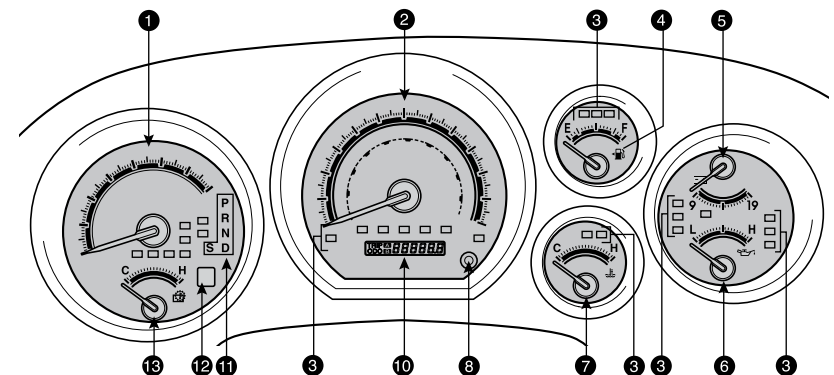

- 1 Tachometer
- 2 Speedometer
- 3 Service indicator and reminder
- 4 Fuel gauge
- 5 Voltmeter
- 6 Engine oil pressure gauge
- 7 Engine coolant temperature
- 8 Odometer/Trip meter and trip meter reset button
- 9 Multi-Information Display
- 10 Odometer and two trip meters
- 11 Automatic Transmission shift position indicator
- 12 Automatic Transmission shift range display
- 13 Automatic Transmission fluid temperature gauge*

* If equipped

Indicator symbols

For details, refer to “Indicators and warning lights,” Section 2-2, 2014 Owner’s Manual.

| | |
|--|---|
| | Brake system warning* |
| | Driver seat belt reminder (alarm will sound if speed is over 12 mph) |
| | Front passenger seat belt reminder (alarm will sound if speed is over 12 mph) |
| | Charging system warning* |
| | AIR BAG ON indicator |
| | AIR BAG OFF indicator* |
| | Malfunction/Check Engine indicator* |
| | Maintenance/Service required indicator |
| | Low fuel level warning |
| | Open door warning |
| | Airbag SRS warning* |
| | Low windshield washer fluid level warning |
| | Master warning |
| | Low Tire Pressure Warning* |
| | Theft deterrent/Engine immobilizer system indicator |
| | Power steering warning* |
| | Roll Sensing of Curtain shield Airbag OFF indicator* |
| | Headlight low/high beam indicator |
| | Turn signal indicator |
| | Shift position and shift range indicators |
| | Vehicle Stability Control OFF indicator* |
| | TOW/HAUL mode indicator |

| | |
|--|---|
| | AUTO Limited Slip Differential indicator* |
| | Slip indicator* |
| | High/Low speed four-wheel drive indicator |
| | Height control indicator* |
| | Height control/MANUAL indicator* |
| | Center differential lock indicator |
| | Cruise control indicator |
| | Anti-lock Brake System warning* |
| | Automatic Transmission fluid temperature warning* |
| | Traction Control OFF indicator* |
| | BSM (Blind Spot Monitor) outside rearview mirror indicators |

* If indicator does not turn off within a few seconds of starting engine, there may be a malfunction. Have vehicle inspected by your Toyota dealer.

Keyless entry

Locking operation

With power back door

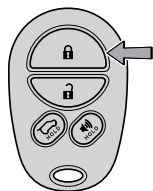

Without power back door

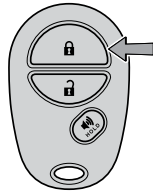

Push

Unlocking operation

With power back door

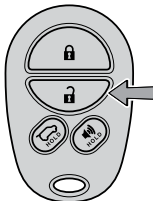

Without power back door

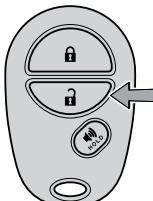

Push ONCE: Driver door
TWICE: All doors



NOTE: If a door is not opened within 60 seconds of unlocking, all doors will relock for safety.

Power back door operation (if equipped)

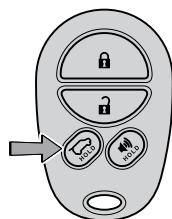

Push and hold



Panic button



Push and hold



Fuel tank door release and cap

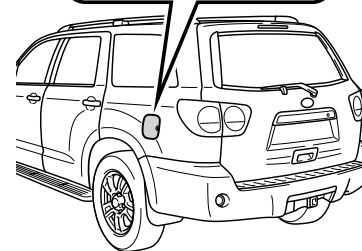
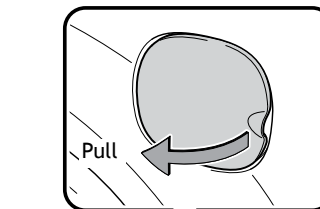

Turn to open

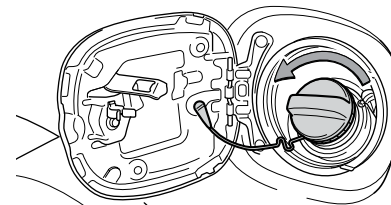

Store

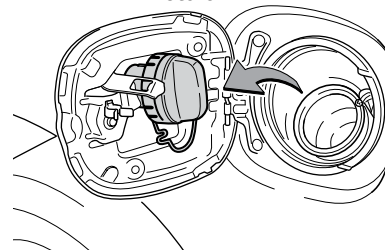

NOTE: Tighten until one click is heard. If the cap is not tightened enough, Check Engine "CHECK" indicator may illuminate.

Light control-Instrument panel

Brightness control

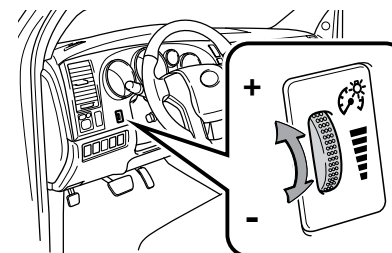

Hood release

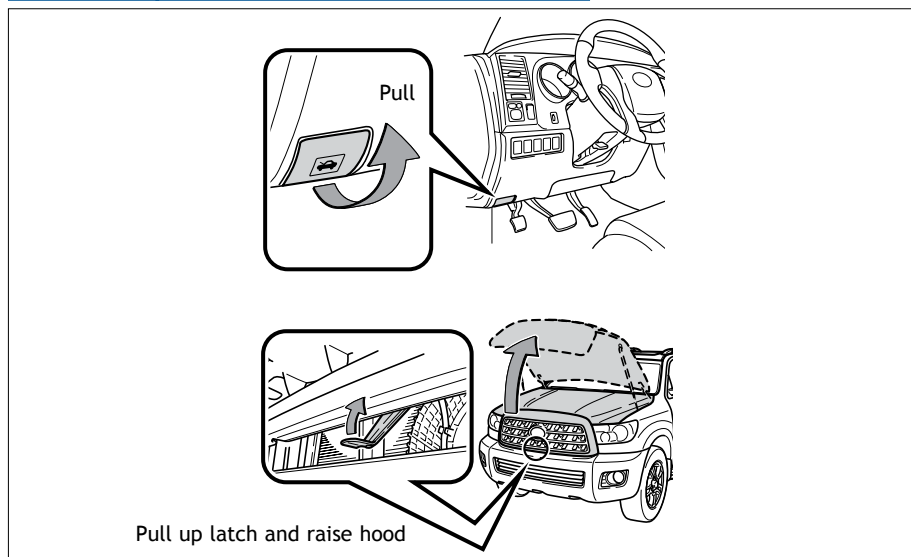

Engine maintenance

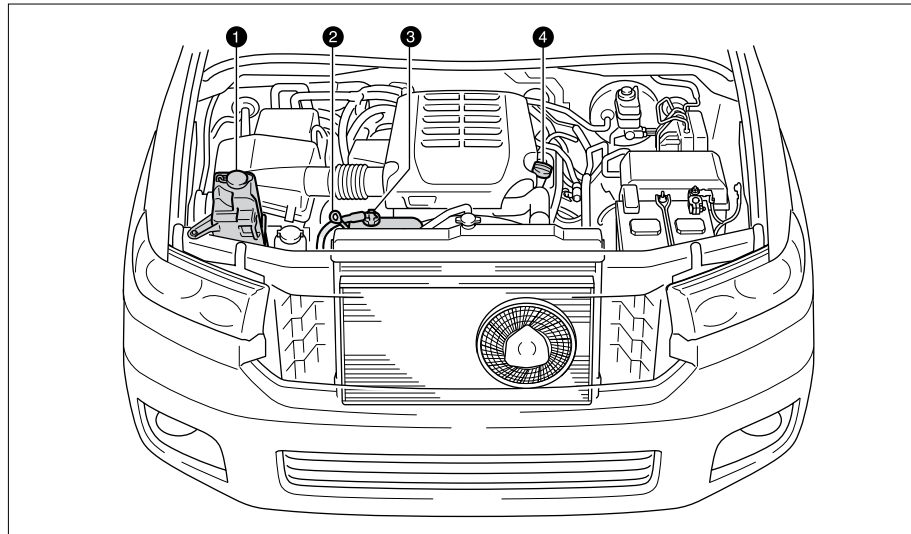

- ❶ Windshield washer fluid tank
- ❷ Engine oil level dipstick
- ❸ Engine coolant reservoir
- ❹ Engine oil filler cap

NOTE: Regularly scheduled maintenance, including oil changes, will help extend the life of your vehicle and maintain performance. Please refer to the "Warranty & Maintenance Guide."

FEATURES/OPERATIONS

Automatic Transmission

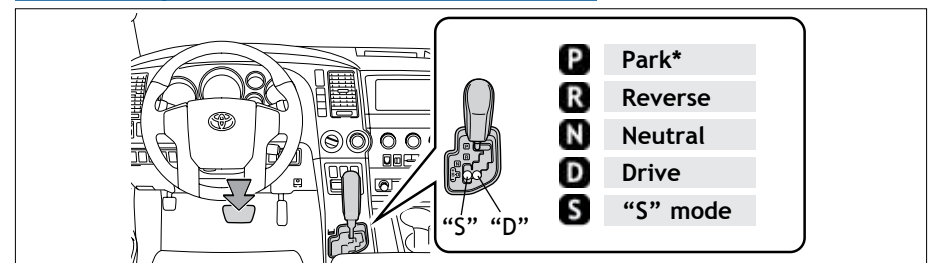

* The ignition switch must be "ON" and the brake pedal depressed to shift from Park.

"S" (Sequential) mode

Shift the shift lever to "S" position from "D" position.

- +: Upshift (push and release)
- : Downshift (pull and release)

Downshifting increases power going uphill, or provides engine braking downhill. For best fuel economy during normal driving conditions, always drive with the shift lever in the "D" position.

TOW/HAUL switch (if equipped)

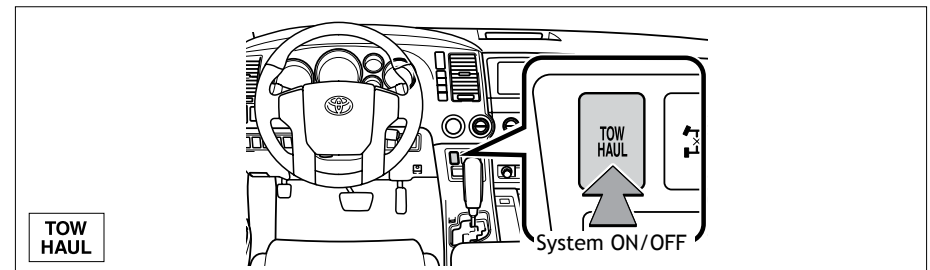

"TOW/HAUL" mode can be used when carrying heavy loads. As fuel economy is reduced while in "TOW/HAUL" mode, deactivating when driving without a load is recommended.

Refer to the *Owner's Manual* for more details on this system before attempting to use it.

Auto lock/unlock

Automatic door locks can be programmed to operate in four different modes, or turned OFF.

- Doors lock when shifting from Park.
- Doors lock when the vehicle speed is approximately 12 mph or higher.
- Doors unlock when shifting into Park.
- Doors unlock when the driver's door is opened within 10 seconds after turning the ignition switch to the "ACC" or "LOCK" position.

Refer to the *Owner's Manual* for more details.

Four-wheel drive (if equipped)

Four-wheel drive control switch

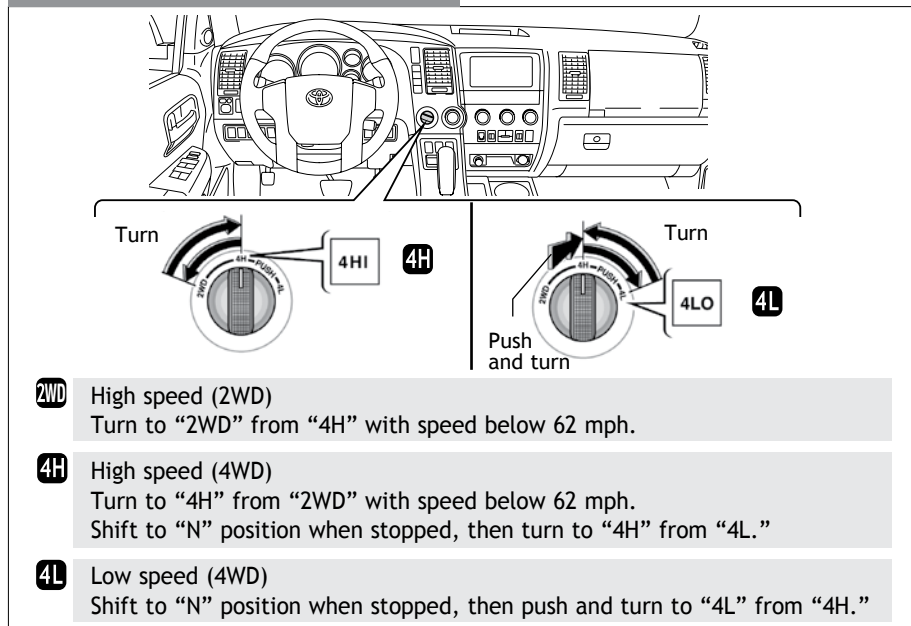

For best fuel economy and performance under normal driving conditions, keep in "2WD" position.

Center differential lock/unlock switch

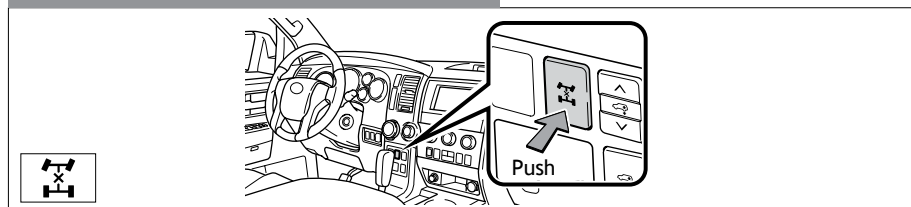

Lock the center differential if the vehicle's wheels get stuck in a ditch or when driving on a slippery or bumpy surface.

Refer to the *Owner's Manual* for more details on this system before attempting to use it.

Parking brake

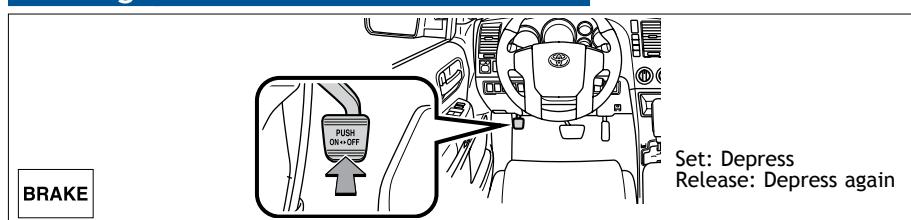

BSM (Blind Spot Monitor)(if equipped)

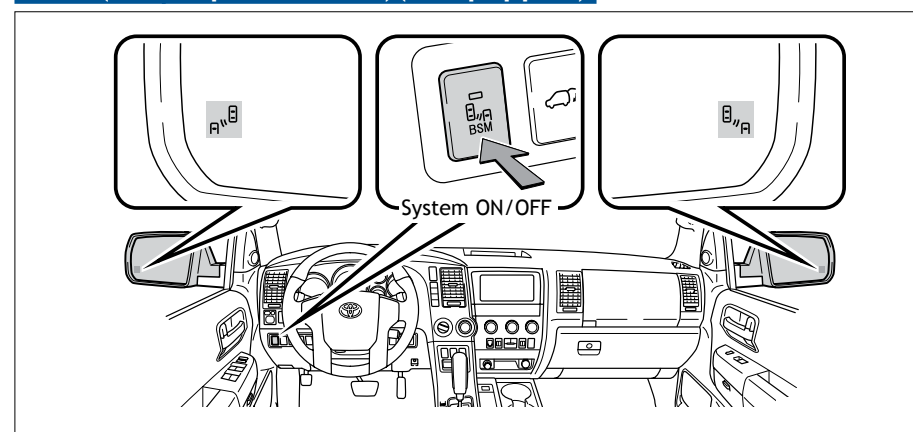

The Blind Spot Monitor is a system that assists the driver to confirm safety when changing lanes. The system uses radar sensors to detect vehicles that are traveling in an adjacent lane in the area that is not reflected in the outside rearview mirror (the blind spot), and advises the driver of the vehicles' existence via the outside rearview mirror indicator.

Refer to the *Owner's Manual* for more details on this system before attempting to use it.

Seats-Head restraints

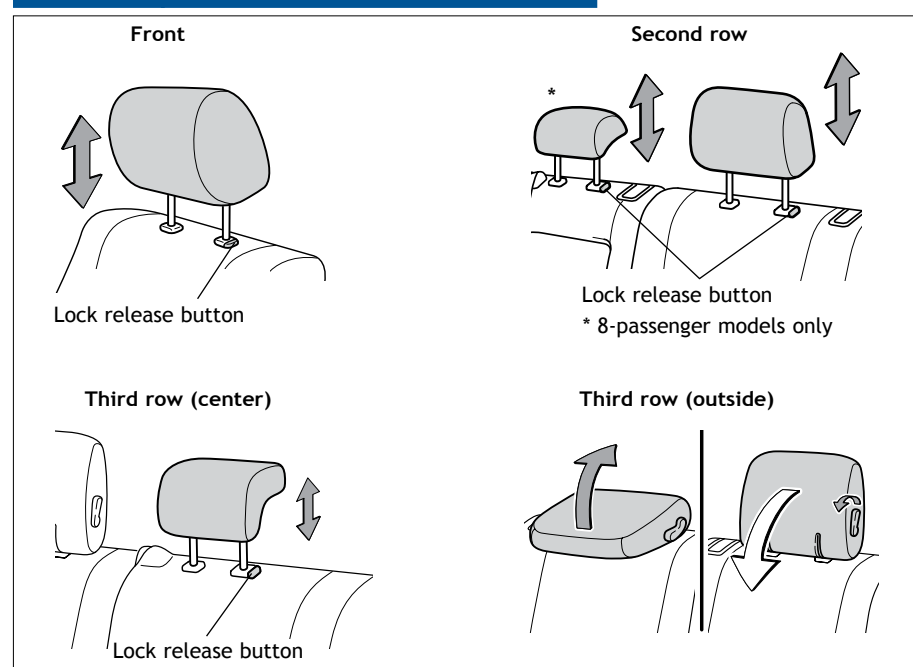

Seat adjustments-Rear

Second row

Separate seat

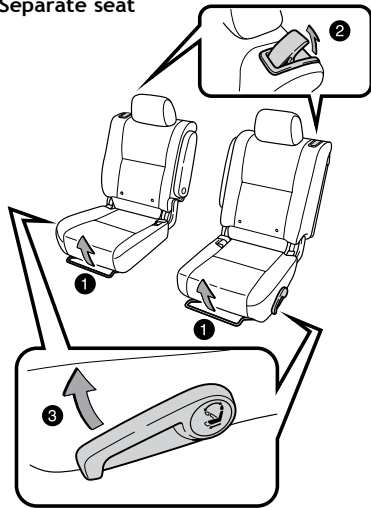

Bench seat

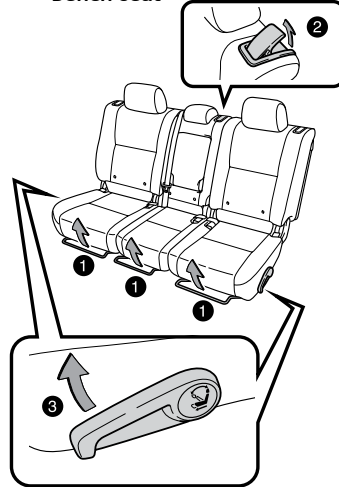

Third row

Manual seat

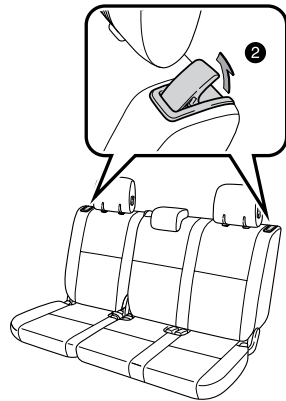

Power seat

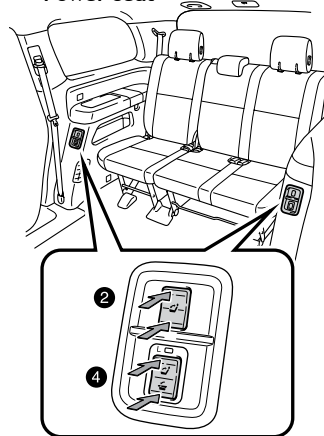

- ① Seat position (forward/backward)
- ② Seatback angle
- ③ Seatback angle/lock release and slide
- ④ Seatback folding/returning

Refer to the *Owner's Manual* for more details.

Seat adjustments-Front

Manual seat

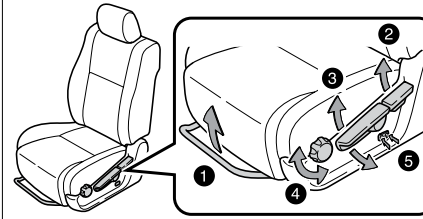

Power seat

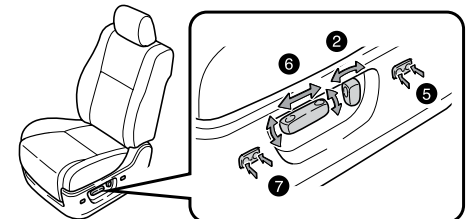

- ① Seat position (forward/backward)
- ② Seatback angle
- ③ Seat height
- ④ Seat cushion angle
- ⑤ Lumbar support
- ⑥ Position, cushion angle and height
- ⑦ Leg support (if equipped)

Seats-Folding second row seats

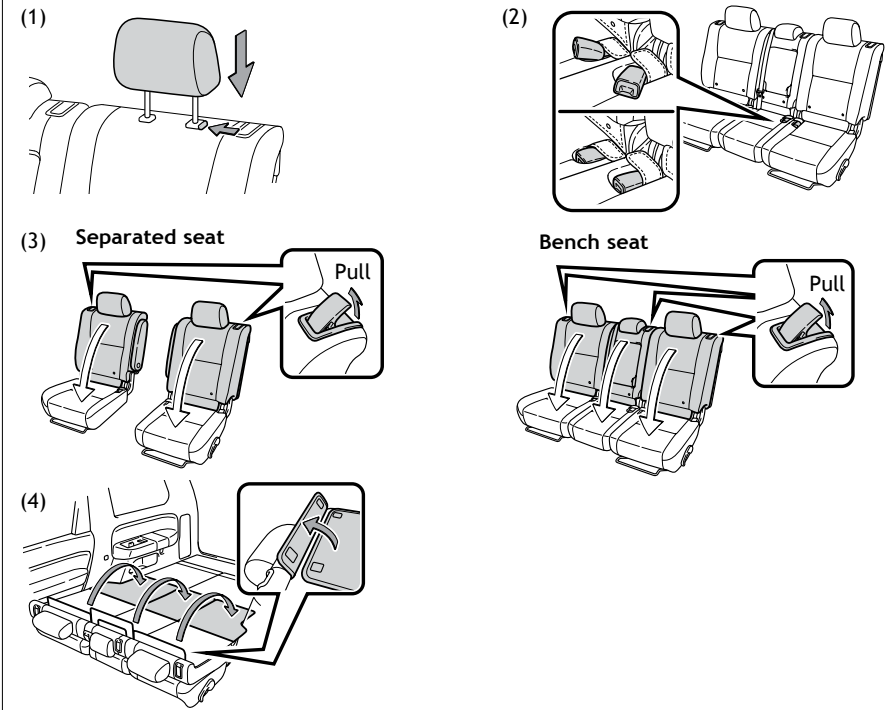

- (1) Lower the head restraints.
- (2) Stow the seat belt buckles.
- (3) Fold down the seatback.
- (4) Fold out the board (if equipped) from the seatback.

Seats-Folding third row seats

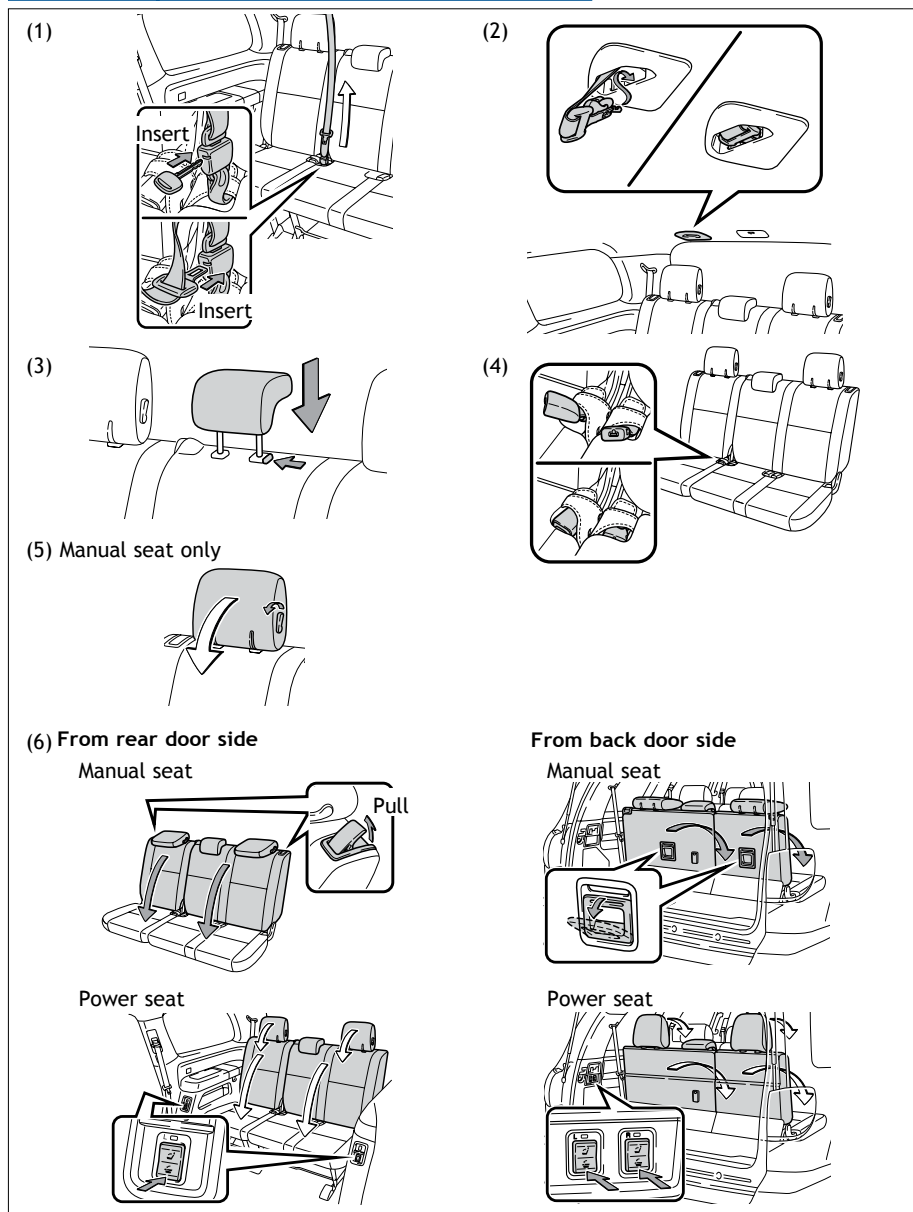

- (1) Release the center seat belt tab.
- (2) Stow the center seat belt tab.
- (3) Lower the head restraint.
- (4) Stow the seat belt buckles.
- (5) Fold the head restraint.
- (6) Fold the seats.

Lights & turn signals

Headlights

Type A

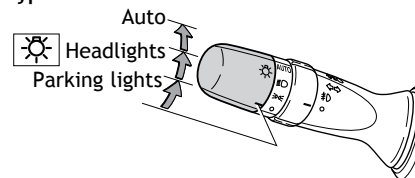

Type B

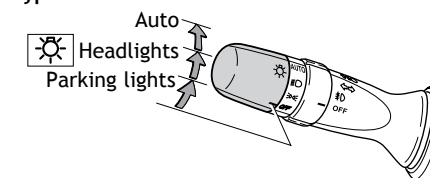

Type C

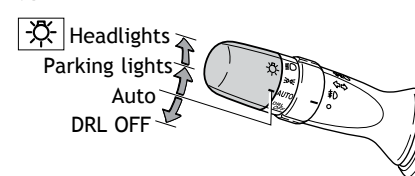

Type D

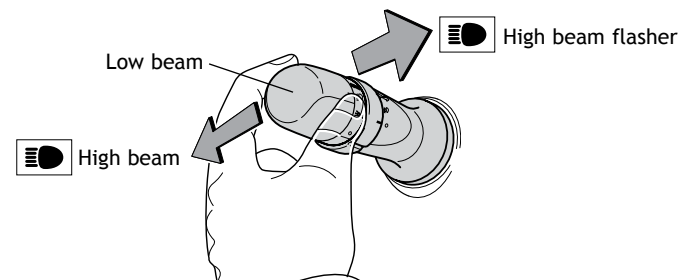
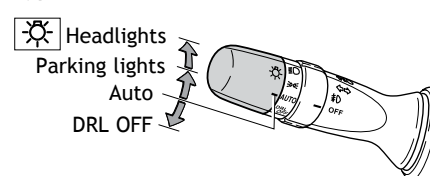

- Daytime Running Light system (DRL) Automatically turns on the front turn signal lights upon starting engine and releasing parking brake.
- Automatic light cut off system Automatically turns lights off after a delay of 30 seconds, or the lock switch on remote may be pushed after locking.

Front fog lights (if equipped)

Type A

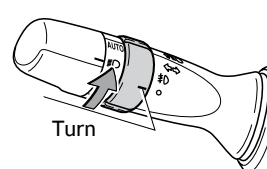

Type B

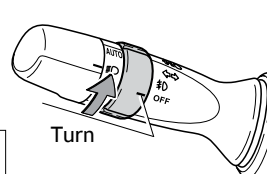

Front fog lights come on only when the headlights are on low beam.

Turn signals

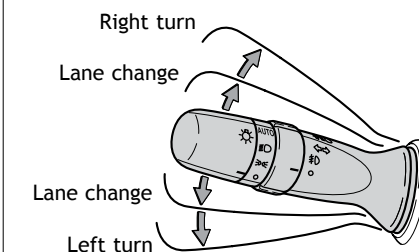

Windshield wipers & washers

Front

Type A

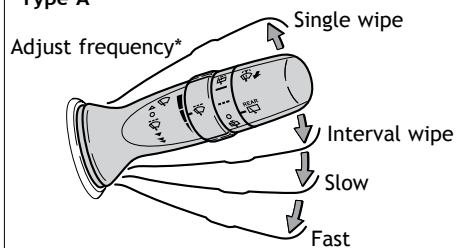

Type B

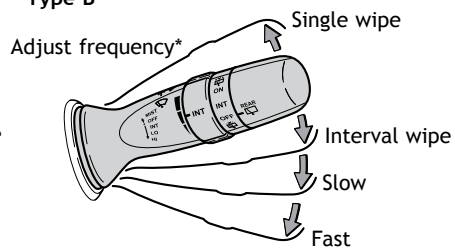

* Intermittent windshield wiper frequency adjustment
Rotate to increase/decrease wipe frequency.

Rear

Type A

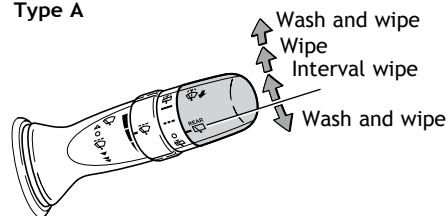

Type B

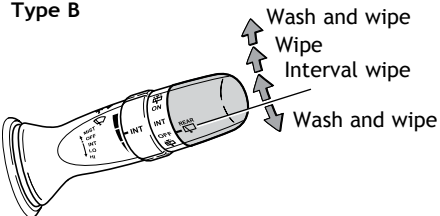

Windows

Driver side

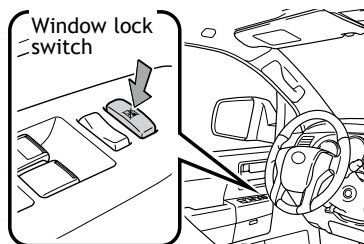
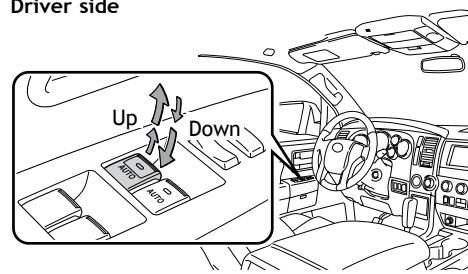

Automatic operation Push the switch completely down or pull it completely up and release to fully open or close. To stop window partway, lightly push the switch in the opposite direction.

Window lock switch Deactivates all passenger windows and back window. Driver's window remains operable.

Window-Back

Operating from inside

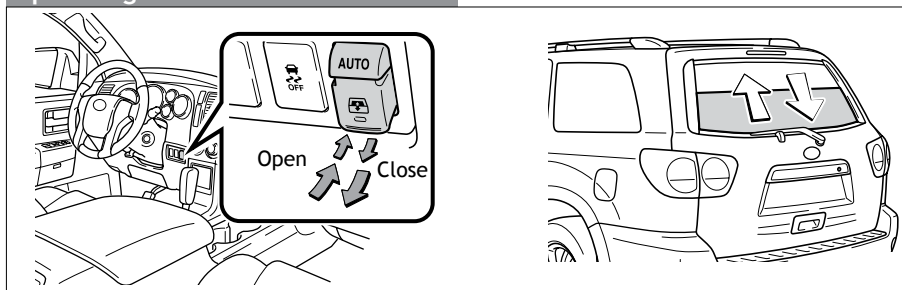

Automatic operation Push the switch completely in or pull it completely out and release to fully open or close. To stop window midway, lightly push the switch in the opposite direction.

Operating from outside

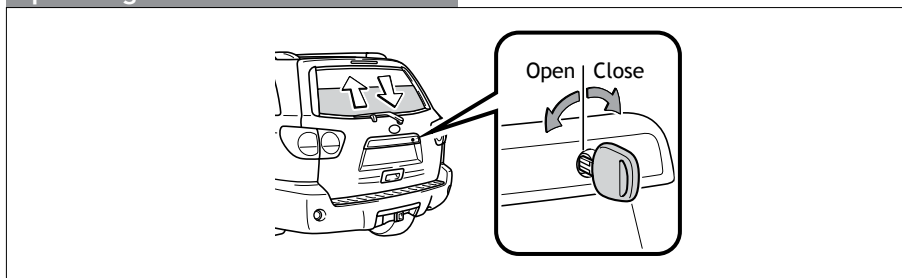

Door-Power back (if equipped)

Instrument panel

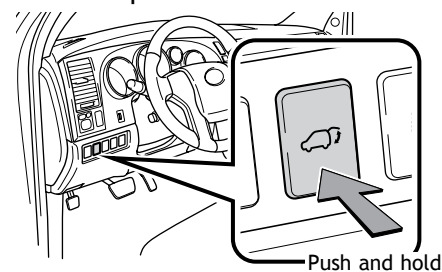

Open: Push and hold
Close: Push and hold again

Back door (close only)

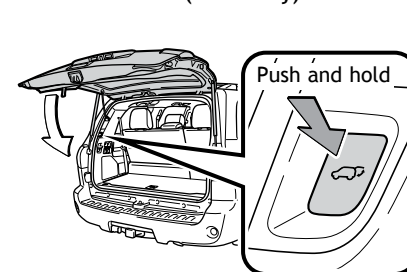

NOTE: If battery is disconnected, the power back door needs to be reinitialized. Refer to the *Owner's Manual* for more details.

Moonroof (if equipped)

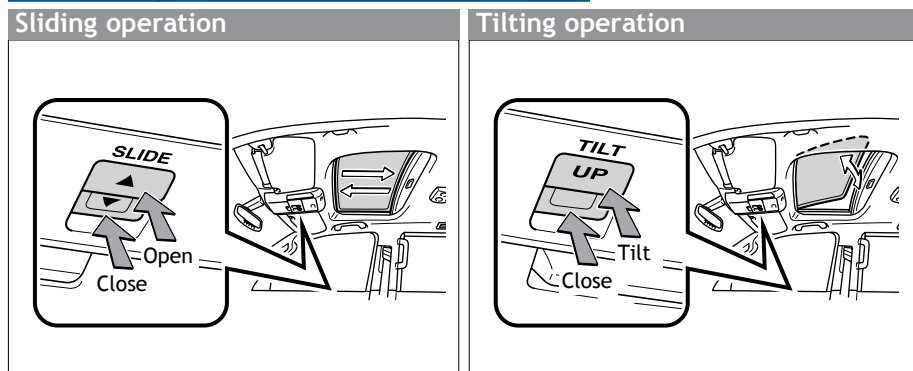

Push to open/close. To stop partway, press the switch lightly.

Accessory meter

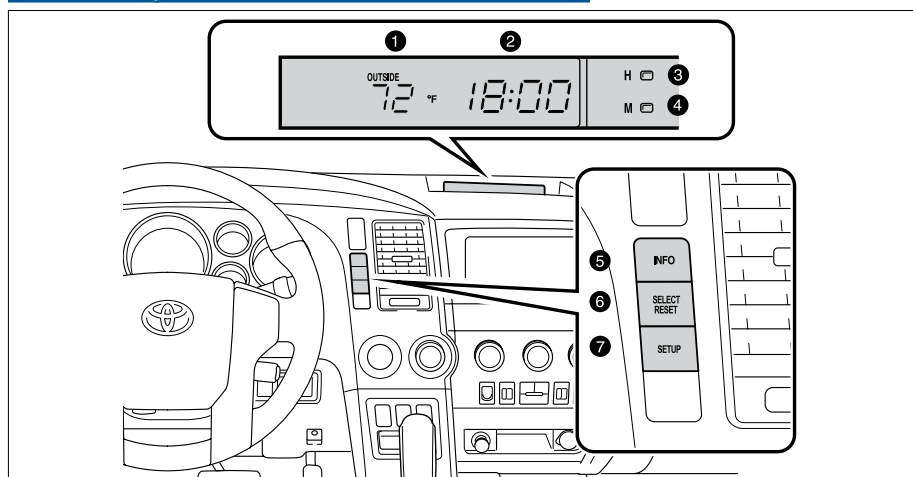

- ① Outside temperature/Cruise information display (if equipped)
- ② Clock
- ③ Hour set
- ④ Minute set
- ⑤ Change information (if equipped)
- ⑥ "SELECT RESET" button (if equipped)
- ⑦ "SETUP" button to customize unit (if equipped)

Refer to your *Owner's Manual* for complete details on this system before attempting to use it.

Tilt and telescopic steering wheel

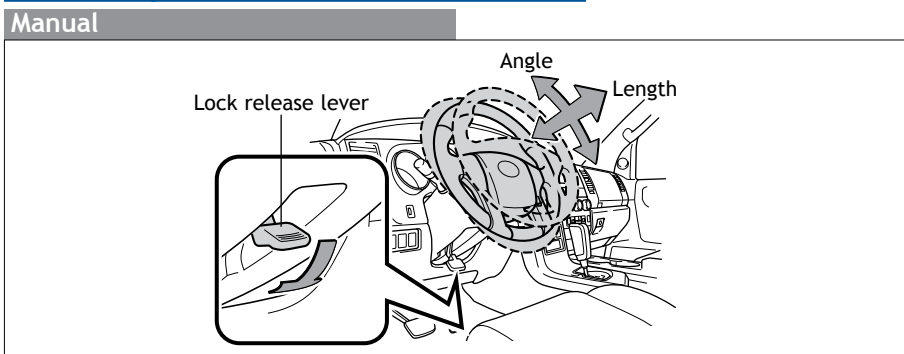

Hold wheel, push lever down, set angle and length and return lever.

Power

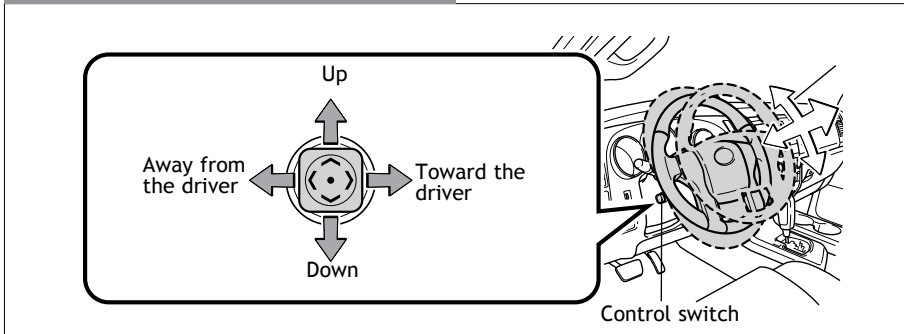

Toggle the control switch to set angle and length.

NOTE: Do not attempt to adjust while the vehicle is in motion.

VSC OFF switch

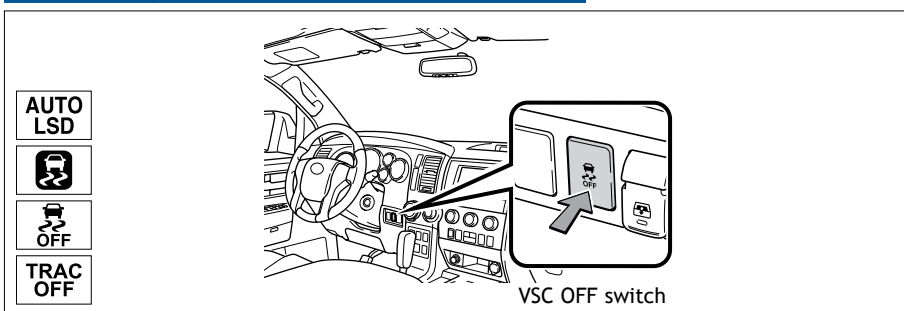

The VSC OFF switch is used to switch between modes related to the TRAC, VSC and Auto LSD functions.

Refer to Section 2-4 of the *Owner's Manual* for more information.

Air Conditioning/Heating

Front Air Conditioning

Control panel

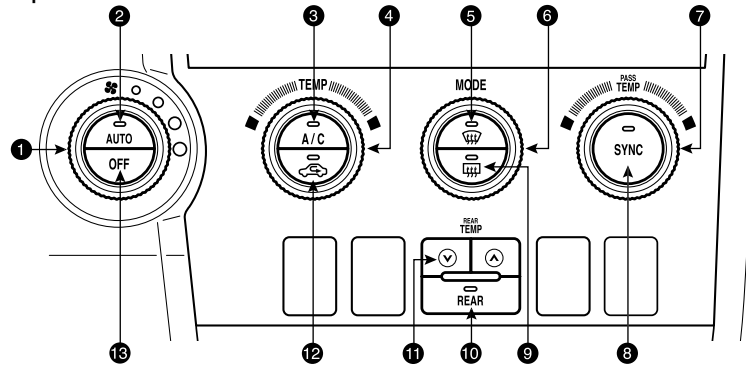

Display

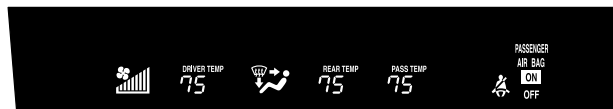

- 1 Fan speed
- 2 Automatic climate control ON
Adjusting the temperature setting will cause the airflow vents, air intake and fan to adjust automatically.
- 3 Air Conditioning ON/OFF
- 4 Temperature selector (driver side)
- 5 Windshield defogger (fresh air only)
- 6 Airflow vent
In “” mode, use fresh air (“” indicator “OFF”) to reduce window fogging.
- 7 Temperature selector (front passenger side)
- 8 “SYNC” button
Indicator ON: Synchronized temperature settings for driver, front passenger and rear seats.
Indicator OFF: Separate temperature settings for driver, front passenger and rear seats.
- 9 Outside rearview mirror/Back window defogger or windshield wiper de-icer (if equipped)
- 10 Rear Air Conditioning ON/OFF
- 11 Temperature selector (rear passenger area*)
- 12 Recirculate cabin air (fresh air when OFF)
- 13 Climate control OFF

* To change the rear seat setting, press the “REAR” button.

Rear Air Conditioning

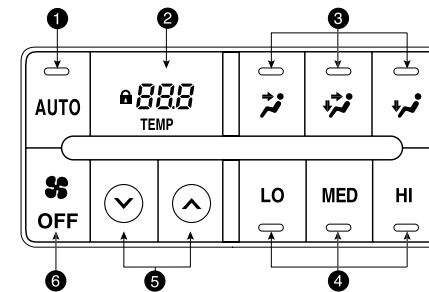

- 1 Automatic climate control ON
- 2 Display
- 3 Airflow vent
- 4 Fan speed
- 5 Temperature selector
- 6 Climate control OFF

Seat ventilators/heaters (if equipped)

Front seats

With ventilators

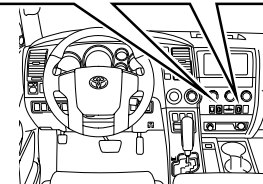
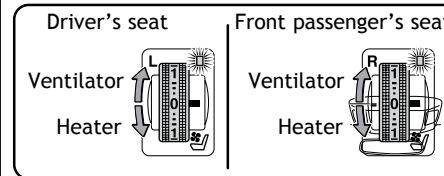

Heater only

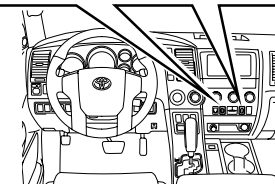
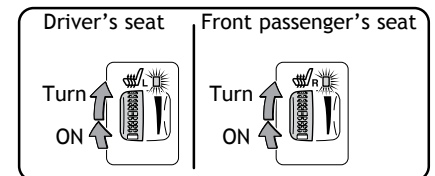

Second seats

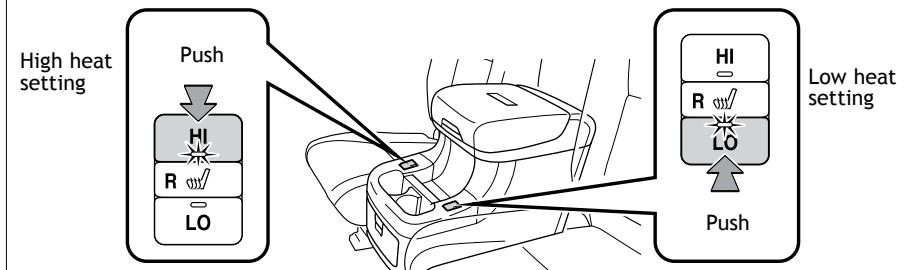

Push lightly in the opposite direction to turn off.

Audio

Entune Audio

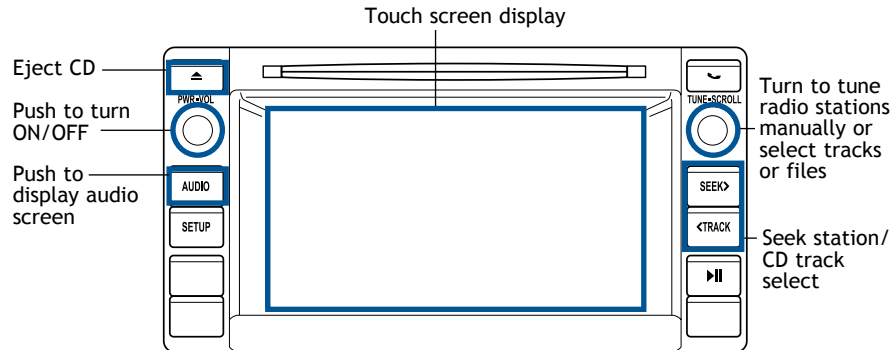

Entune Audio Plus*1/Entune Premium Audio*1/Entune Premium JBL Audio*1

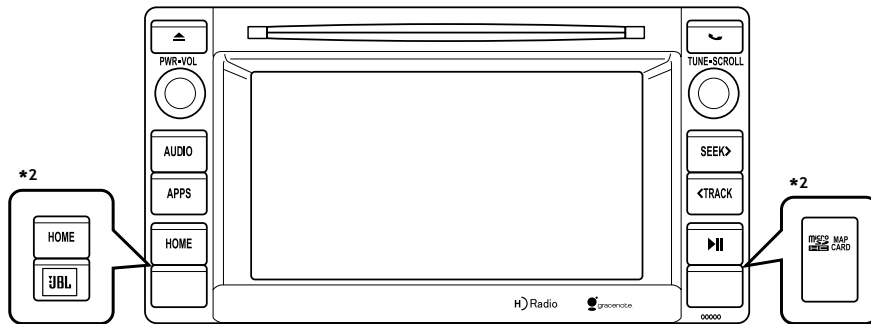

*1 Refer to the "Navigation System Owner's Manual" for instruction.

*2 Entune Premium Audio

Steering wheel switches (if equipped)

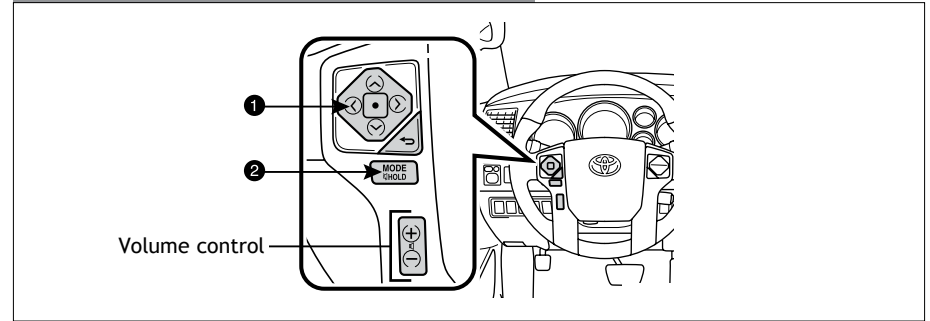

① "▲ ▼" "< >"

Use to search within the selected audio medium (radio, CD, iPod®, etc.).

② "MODE"

Push to turn audio ON and select an audio mode. Push and hold to mute or pause the current operation.

iPod®/USB/AUX port

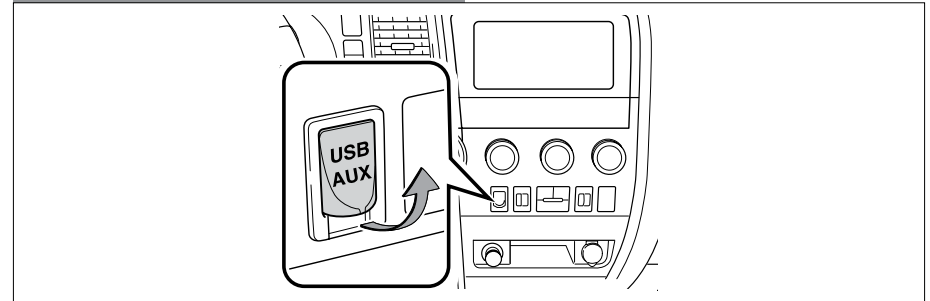

iPod®/USB port

By connecting a USB-compatible portable audio device or USB memory to the USB port, you can listen to music from the portable audio device or USB memory through the vehicle's speaker system.

AUX port

By inserting a mini plug into the AUX port, you can listen to music from a portable audio device through the vehicle's speaker system while in AUX mode.

Entune™ Audio Plus



- 1 AUDIO Button
Access to audio functions.
- 2 HOME Button
Access to Home screen.
- 3 APPS Button
Access to features such as fuel consumption, traffic, and weather.



HOME SCREEN - the home screen offers a two panel and a three panel layout. Information and layout will vary depending on selected set up.

NOTE: Console configuration and position of buttons may vary in some vehicles.

Quick Tip - The USB and AUX port location and design are different depending on the vehicle. For details, see page 25.

Traffic



The Traffic App displays a scrollable map showing local traffic in 3 colors. Traffic conditions are displayed in red, yellow and green for heavy, moderate or light traffic conditions. Use  or  arrows to scroll the map up or down.

Weather

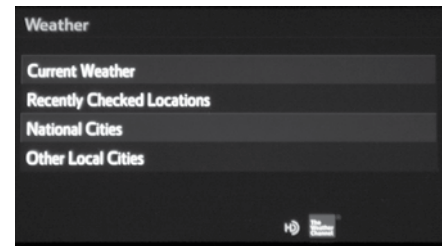

The Weather App options show current weather and recently checked locations weather. You can also search for a weather forecast by national or local cities.

Always drive safely, obey traffic laws & focus on the road while driving. Availability and accuracy of the information provided by HD services is dependent upon many factors. Services not available in every city or roadway. Use common sense when relying on information provided. HD Radio(tm) Technology manufactured under license from iBiquity Digital Corporation U.S. and Foreign Patents. HD Radio(tm) and the HD, HD Radio, and "Arc" logos are proprietary trademarks of iBiquity Digital Corp.

Garage door opener (HomeLink®)* (if equipped)

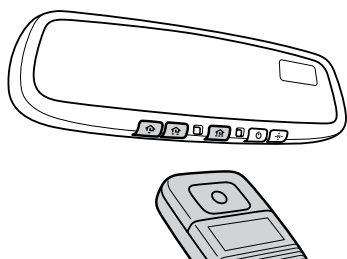

Garage door openers manufactured under license from HomeLink®* can be programmed to operate garage doors, estate gates, security lighting, etc.

Refer to “Garage door opener,” Section 3-5 in the *Owner’s Manual* for more details.

For programming assistance, contact HomeLink® at 1-800-355-3515, or visit <http://www.homelink.com>.

* HomeLink® is a registered trademark of Johnson Controls, Inc.

Cruise control

Turning system ON/OFF

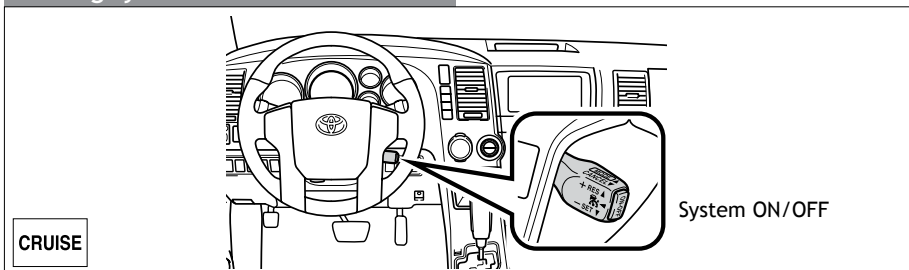

Functions



¹ The set speed may also be cancelled by depressing the brake pedal.

² The set speed may be resumed once vehicle speed exceeds 25 mph.

Dynamic Laser Cruise Control (if equipped)

Refer to the *Owner’s Manual* for more details and complete safety precautions before attempting to use “Dynamic Laser Cruise Control.”

Fixed speed mode



- (1) To select conventional/fixed speed control Push the ON-OFF button. Push the lever forward and hold.
- (2) To set, cancel and resume a speed Refer to instructions for *Cruise Control* in this guide.

Distance control mode

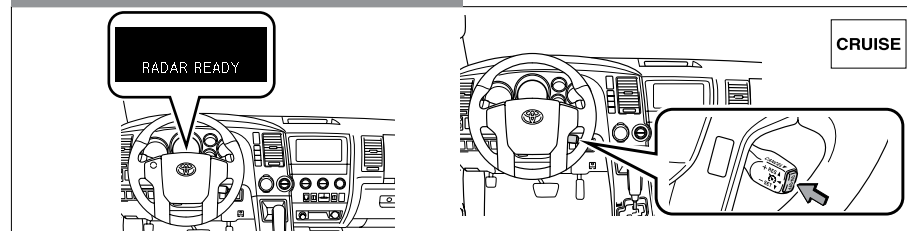

Distance control mode will cruise at a set speed, decelerate to maintain selected distance from a slower vehicle traveling in front of you, and accelerate back up to the selected speed if the vehicle traveling in front of you changes lanes or speeds up.

- (1) To select distance control mode Push the ON-OFF button. The “CRUISE” indicator will come on.
- (2) To set, cancel and resume a speed Refer to instructions for *Cruise Control* in this guide.

NOTE: Once vehicle speed is set, pushing lever up toward “+ RES” will increase speed to the nearest 5 mph, and then in 5 mph increments. Pushing lever down toward “- SET” will reduce speed in the same way.

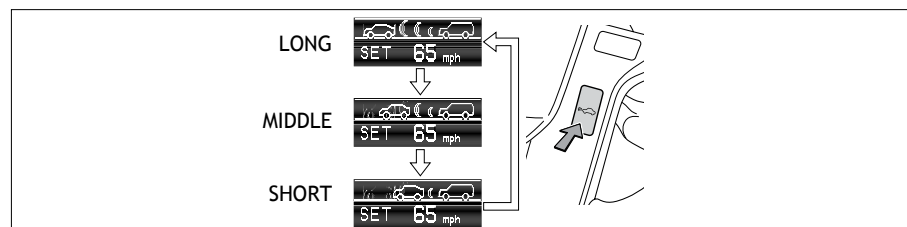

- (3) To change the vehicle-to-vehicle distance Push the distance button to cycle through the settings, which will change progressively from LONG to MIDDLE to SHORT.

Multi-Information Display (if equipped)

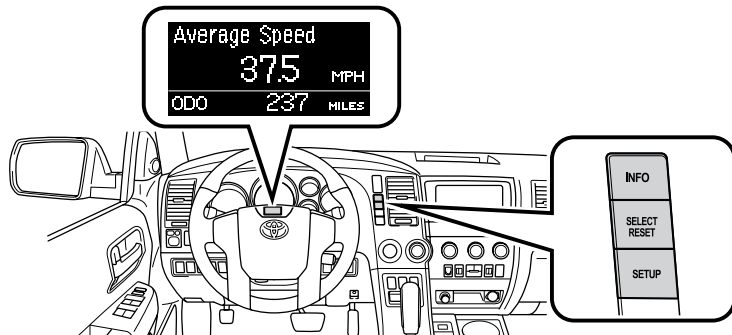

Push “INFO” to change information in the following:

- (1) Zoom display of odometer and trip meter
- (2) Average gas mileage
- (3) Current gas mileage
- (4) Miles left on remaining fuel
- (5) Running time from engine start
- (6) Average vehicle speed

Push “SETUP” to customize to the following settings:

- (1) UNIT
- (2) KEYLESS ENTRY FEEDBACK
- (3) KEYLESS ENTRY RELOCK TIMER
- (4) KEYLESS ENTRY ALL DOORS UNLOCK
- (5) DOOR AUTO LOCKING
- (6) DOOR AUTO UNLOCKING
- (7) HEADLAMPS AUTO OFF TIMER
- (8) COURTESY LAMPS OFF TIMER
- (9) LANGUAGE
- (10) DEFAULT SETTING

Door locks

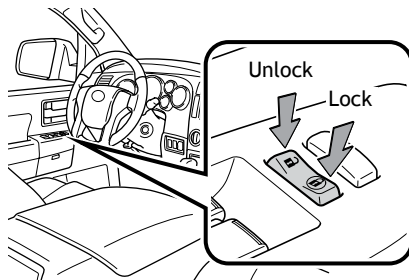

Telephone controls (Bluetooth®) (if equipped)

Audio unit

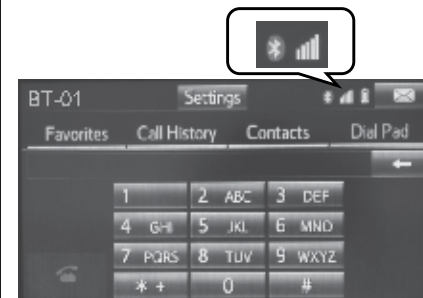

Microphone

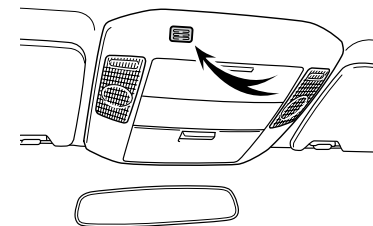

Steering wheel telephone switches

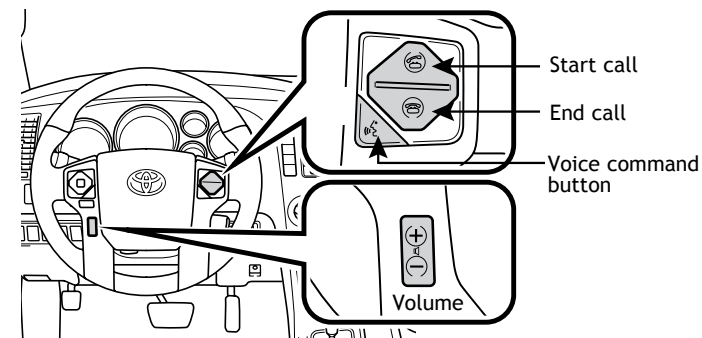

Bluetooth® technology allows dialing or receipt of calls without taking hands from the steering wheel or using a cable to connect the compatible telephone and the system.

Refer to “Using a Bluetooth® phone” Section 3-2 in the *Owner’s Manual*, for more details.

Power outlets-12V DC (if equipped)

Instrument panel

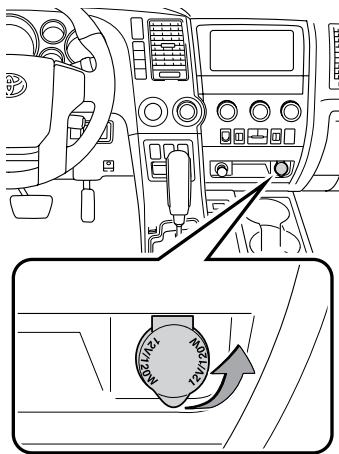

Inside of the center console box

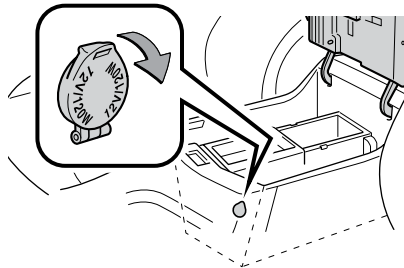

Back of the center console box

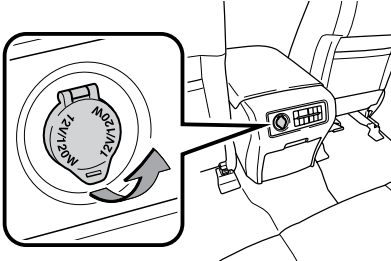

Luggage compartment

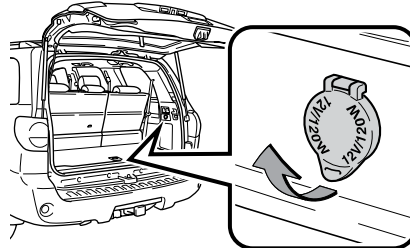

Key must be in the "ACC" or "ON" position to be used.

Power outlets-120V AC (if equipped)

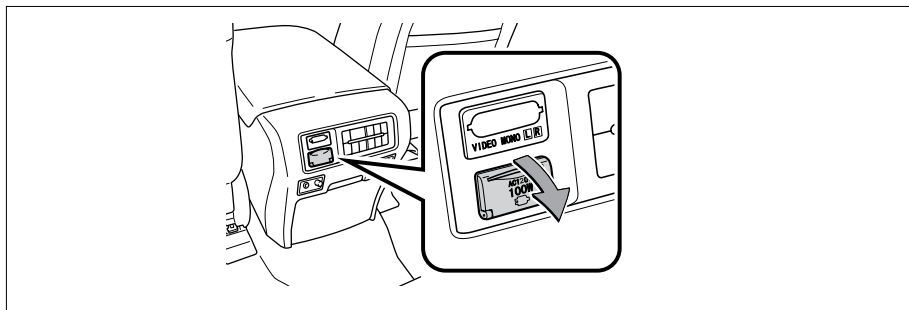

Key must be in the "ON" position to be used.

Rear seat entertainment system (if equipped)

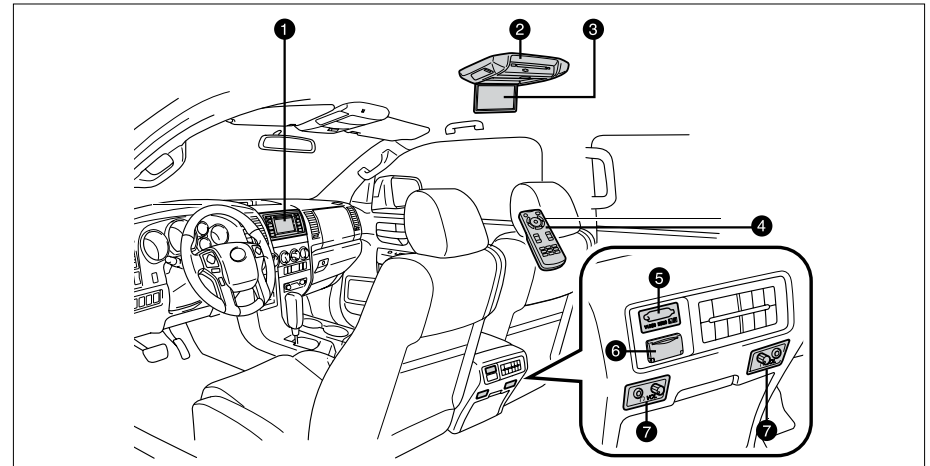

- ① Front audio system
- ② DVD player
- ③ DVD screen
- ④ Remote control
- ⑤ A/V input port
- ⑥ 120V AC power outlet
- ⑦ Headphone volume controls and headphone jacks

For details, refer to the "Navigation System Owner's Manual."

Cup holders

Front

Front console

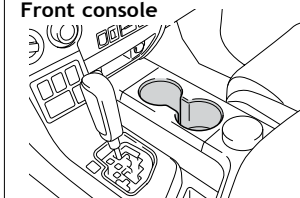

Back of the front console

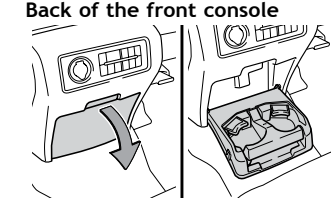

Rear

Rear side trim

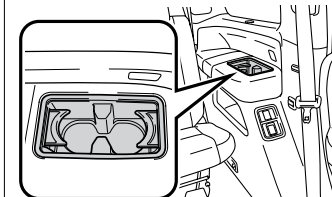

Rear console box (if equipped)

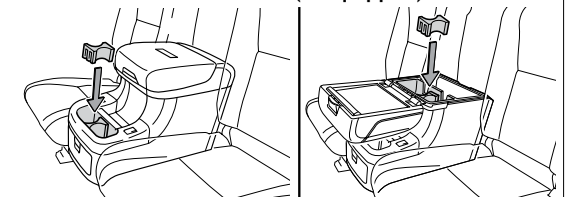

SAFETY AND EMERGENCY FEATURES

Tire Pressure Monitoring (warning) System

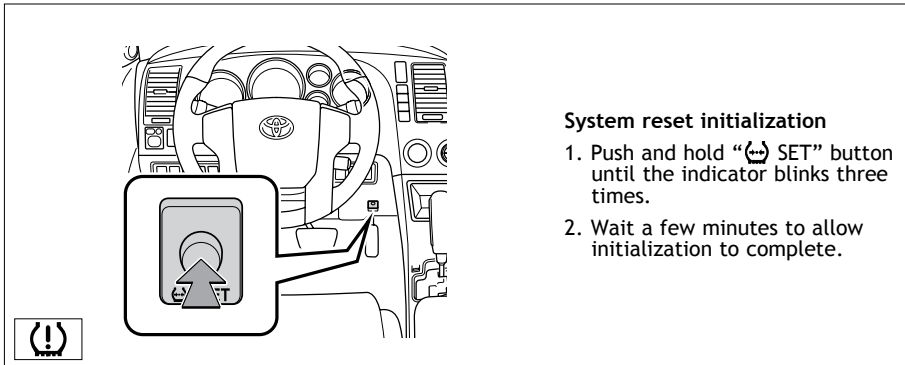

After adjusting tire pressures, or after tires have been rotated or replaced, turn the ignition switch to “ON” and press and hold the “SET” button until indicator blinks three times. Let the vehicle sit for a few minutes to allow initialization to complete.

Refer to the load label on the door jamb or the *Owner's Manual* for tire inflation specifications.

If the tire pressure indicator flashes for more than 60 seconds and then remains on, take the vehicle to your local Toyota dealer.

NOTE: The warning light may come on due to temperature changes or changes in tire pressure from natural air leakage. If the system has not been initialized recently, setting the tire pressures to factory specifications should turn off the light.

Seat belts

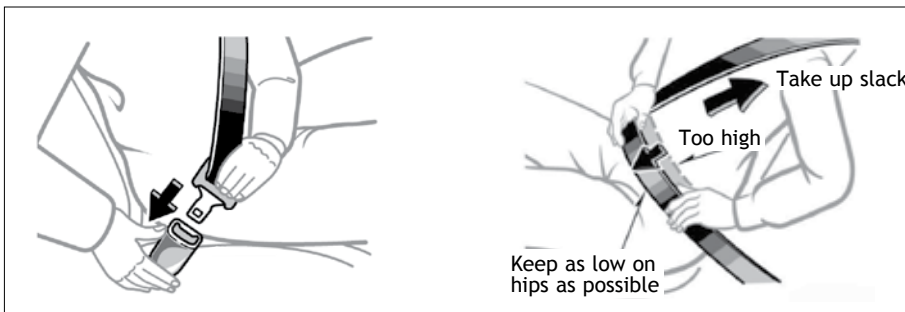

If belt is fully extended, then retracted even slightly, it cannot be re-extended beyond that point, unless fully retracted again. This feature is used to help hold child restraint systems securely.

To find more information about seat belts, and how to install a child restraint system, refer to the *Owner's Manual*.

Seat belts-Shoulder belt anchor

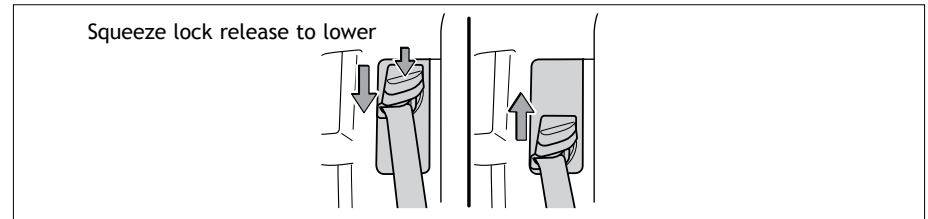

Doors-Child safety locks

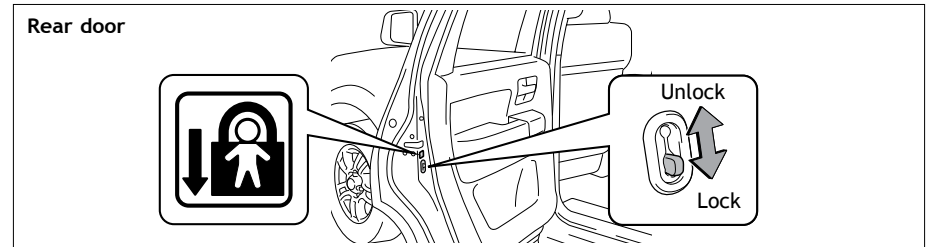

Moving the lever downward will allow the door to be opened only from the outside.

Spare tire & tools

Spare tire, jack and tool location

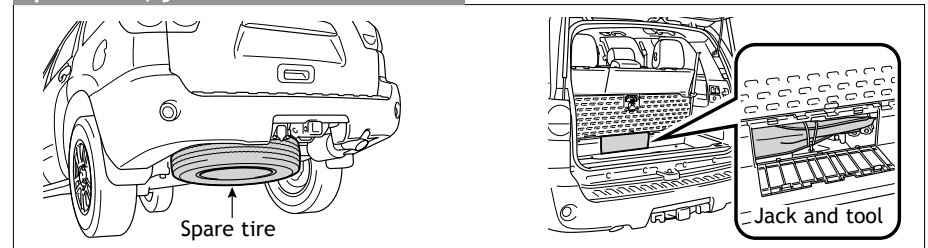

Removing the spare tire

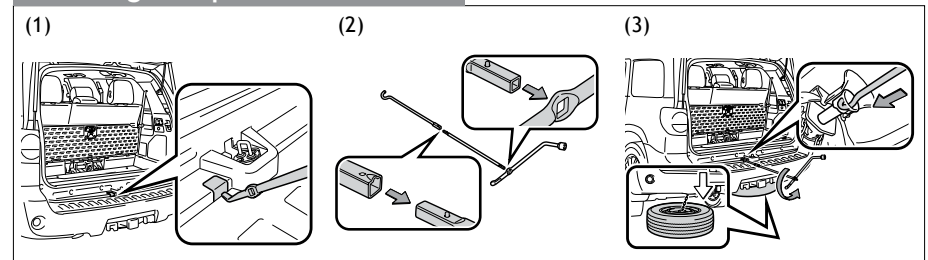

- (1) Remove the cover.
- (2) Assemble the jack handle.
- (3) Insert the jack handle extension into the lowering screw. Lower the spare tire completely to the ground.

Refer to the *Owner's Manual* for tire changing and jack positioning procedures.

Star Safety System™

All new Toyota vehicles come standard with the Star Safety System™, which combines Vehicle Stability Control (VSC), Traction Control (TRAC), Anti-lock Braking System (ABS), Electronic Brake-force Distribution (EBD), Brake Assist (BA) and Smart Stop Technology (SST).

Vehicle Stability Control (VSC)

VSC helps prevent loss of traction during cornering by reducing engine power and applying brake force to selected wheels.

Toyota's VSC monitors steering angle and the direction your vehicle is traveling. When it senses that the front or rear wheels begin to lose traction, VSC reduces engine power and applies braking to selected wheels. This helps restore traction and vehicle control.

Traction Control (TRAC)

VSC helps prevent loss of traction during cornering by reducing engine power, and Traction Control helps maintain traction on loose gravel and wet, icy, or uneven surfaces by applying brake force to the spinning wheel(s).

Toyota's TRAC sensors are activated when one of the drive wheels starts to slip. TRAC limits engine output and applies the brakes to the spinning wheel. This transfers power to the wheels that still have traction to help keep you on track.

Anti-Lock Brake System (ABS)

ABS helps prevent brakes from locking up by “pulsing” brake pressure to each wheel. This limits brake lockup and helps provide directional control for the current road conditions.

Toyota's ABS sensors detect which wheels are locking up and limits wheel lockup by “pulsing” each wheel's brakes independently. Pulsing releases brake pressure repeatedly for fractions of a second. This helps the tires attain the traction that current road conditions will allow, helping you to stay in directional control.

Electronic Brake Force Distribution (EBD)

Toyota's ABS technology has Electronic Brake-force Distribution (EBD) to help maintain control and balance when braking. Abrupt stops can cause a vehicle to tilt forward, reducing the braking power of the rear wheels. EBD responds to sudden stops by redistributing brake force to enhance the braking effectiveness of all four wheels.

Brake Assist (BA)

Brake Assist is designed to detect sudden or “panic” braking, and then add braking pressure to help decrease the vehicle's stopping distance. When there's only a split second to react, Brake Assist can add additional brake pressure more quickly than just the driver alone can.

Smart Stop Technology (SST)

Smart Stop Technology automatically reduces engine power when the accelerator and brake pedals are pressed simultaneously under certain conditions.

SST engages when the accelerator is depressed first and the brakes are applied firmly for longer than one-half second at speeds greater than five miles per hour.

SST doesn't engage if the brake pedal is depressed before the accelerator pedal, allowing vehicles to start on a steep hill and safely accelerate without rolling backward.

Floor mat installation

There are two types of Toyota floor mats: carpeted and all-weather. Each vehicle has model-specific floor mats. Installation is easy.

To keep your floor mat properly positioned, follow these steps:

- Only use floor mats designed for your specific model.
- Use only one floor mat at a time, using the retaining hooks to keep the mat in place.
- Install floor mats right side up.

